

Team A-2

DAVID BRAMER

TIM TRUJILLO

赵楠

寿洋

曲锐思

傅潇

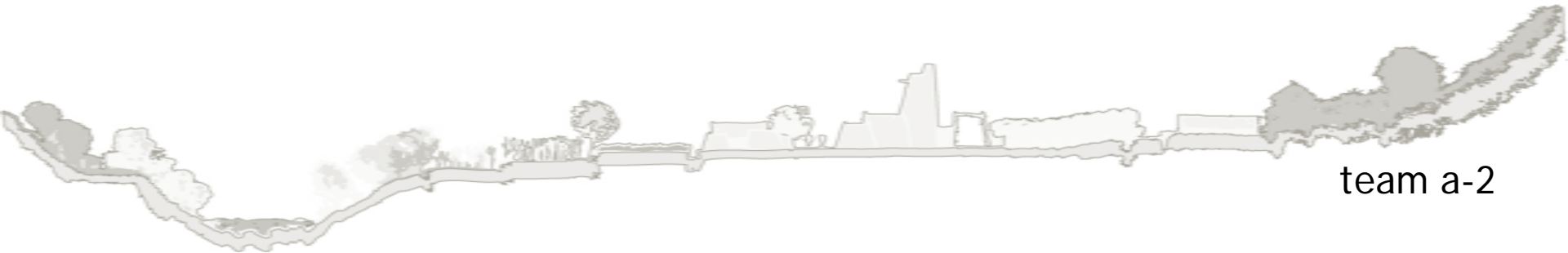

team a-2

Goals 设计目标

Historical Appearance/Updated Safety

历史的外观 / 现代的安全系数

3-floor Height Maximum

最高三层

Grey Water System

水的再利用系统

Sustainability

可持续性

Dance Performances (Shalang)

羌舞表演 (沙朗)

Solar Energy

太阳能

Beliefs

信仰

Crafts

手工艺品

Gardens

花园

Economic Development

经济发展

Density

密集度

Smaller Scale Hotels

小型旅馆

Qiang Architecture

羌族建筑

Public spaces

公共空间

Organic Road System

有组织的道路系统

team a-2

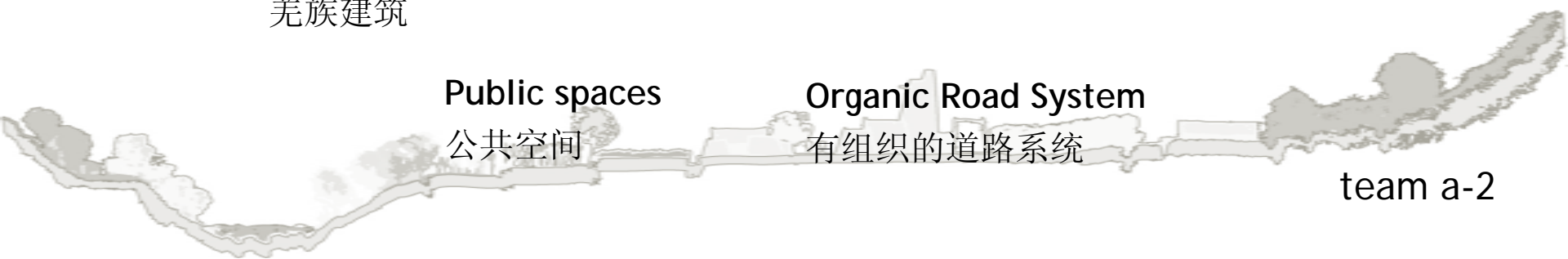

Design Principles 设计原则

- Renovate and re-invigorate the commercial new town by using historic cultural practices.
- 通过历史文化活动，振兴和恢复商业新区活动
- Provide a showcase of sustainable and ecologically responsive technologies to increase tourism.
- 提供可持续发展的，具有生态回应性的技术示范来推动旅游业
- Retrofit the old town and introduce safety standards in new construction to mitigate hazardous risks.
- 修复古寨，保证新寨安全标准→规避灾害

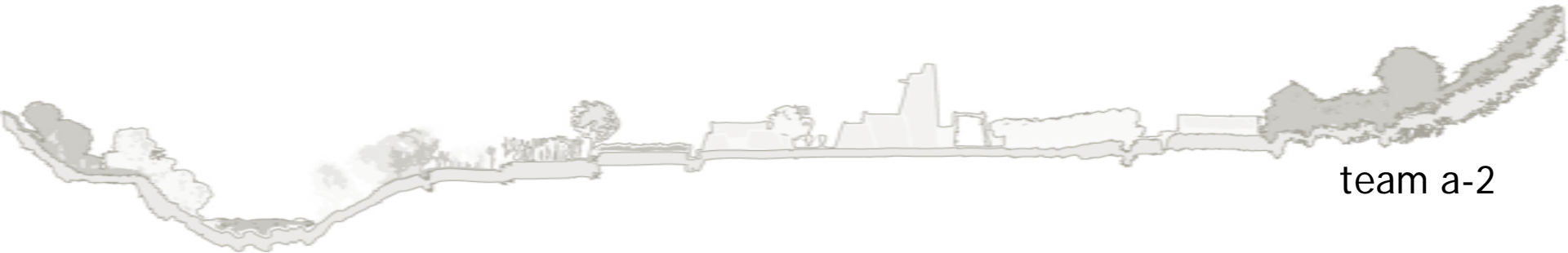

Policy Themes 策略

- Technology - energy usage optimization
- 技术—能源利用最优化

- Cultural Preservation - education
- 文化保护—教育

- Economic Development - tourism as an engine
- 经济发展—旅游作为引擎

- Ecological Preservation - preserve and restore
- 生态保护—保护和恢复

- Villager relocation - establishment of village-run cooperative
- 居民安置—建立村寨社区经济

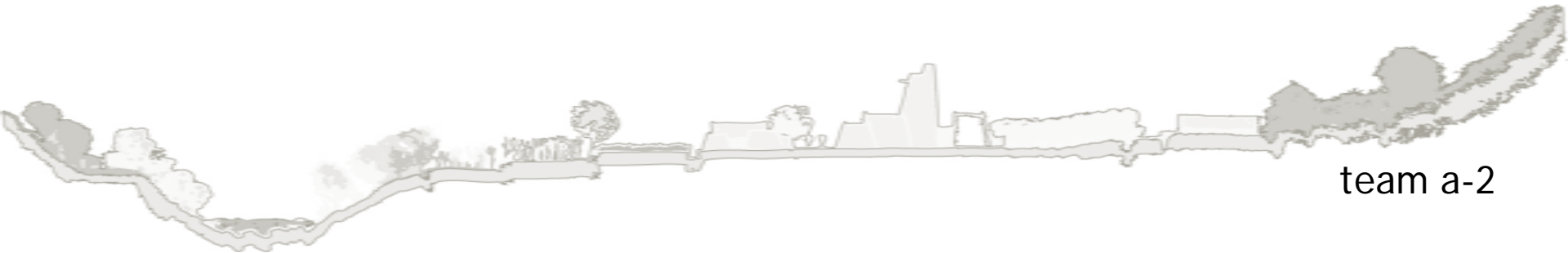

Existing Plan 现行计划

- Poor integration of new and old
- 新旧村寨难以形成一个整体
- New village scale is inconsistent with old village
- 新旧村寨规模不相符
- Significant ecological consequences
- 给生态带来的巨大影响



Site Concept Plan 场地概念规划

- Shaped by the goals, design principles, and policies
- 根据设计目标，设计原则与设计策略成型

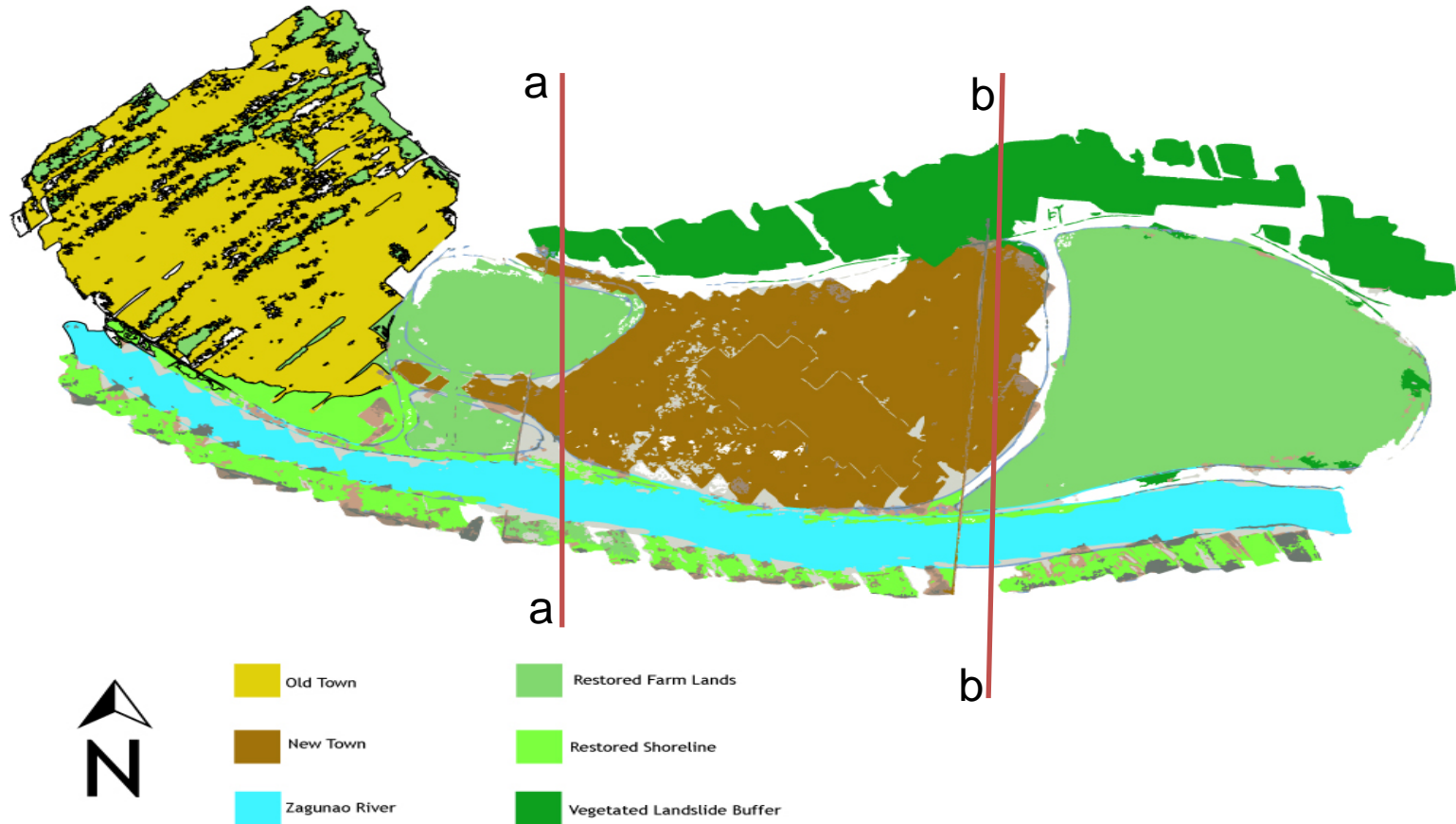



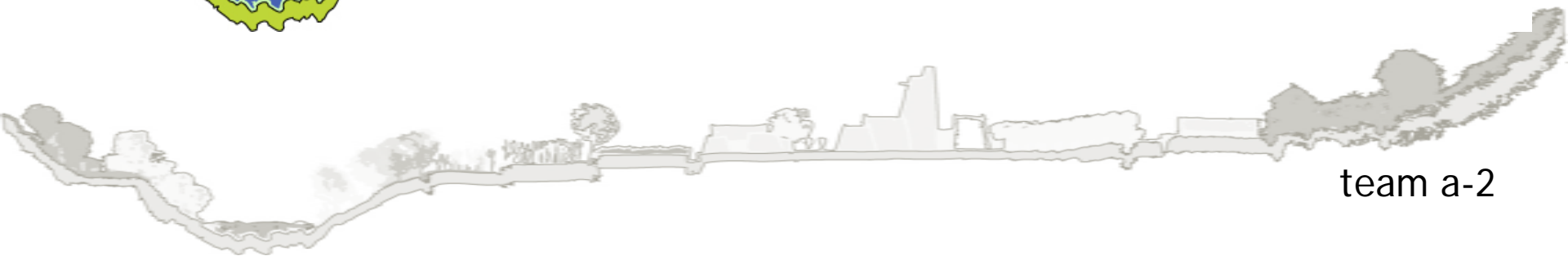
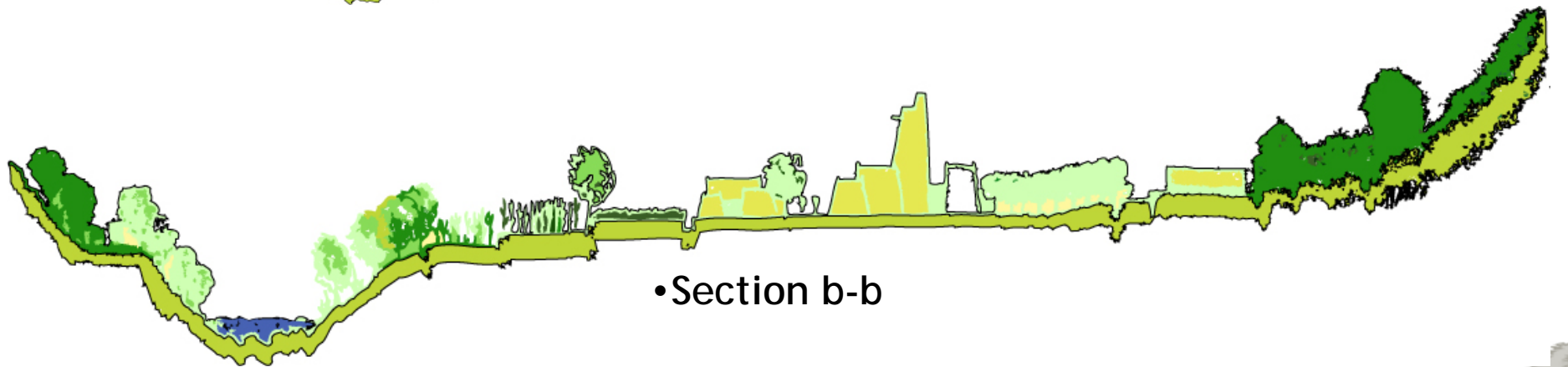
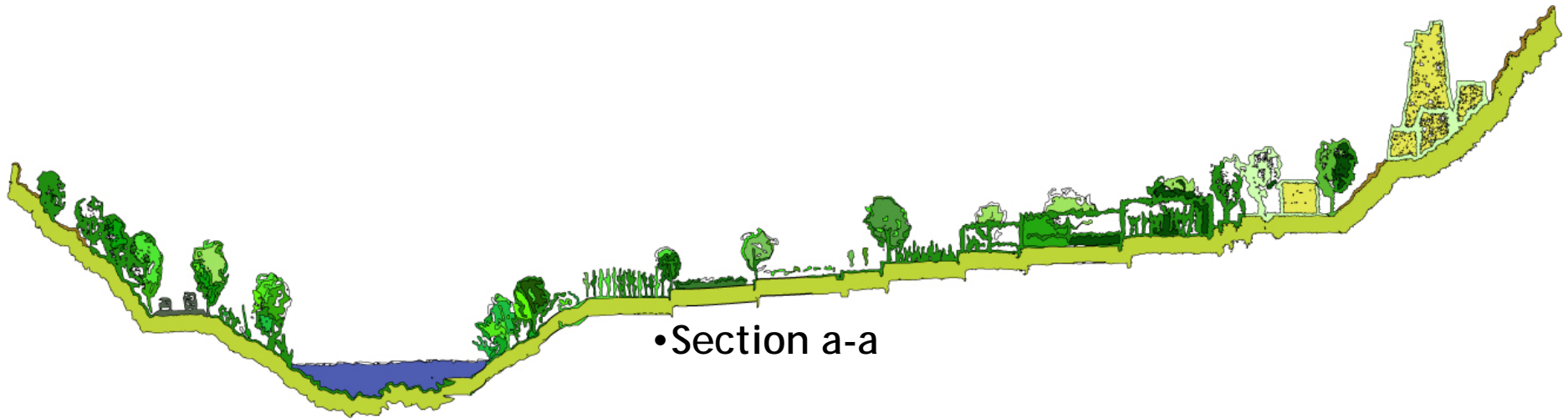



Cross Sections 场地剖面



Vegetation/Agriculture Land Restoration 植被恢复/作物生产



- | | |
|---------------------------------------------------------------------------------------------------|----------------------------------------------------------------------------------------------------------------|
|  Old Town |  Restored Farm Lands |
|  New Town |  Restored Shoreline |
|  Zagunao River |  Vegetated Landslide Buffer |

DESIGN GUIDELINES

设计导则

- 3-story maximum in new village
- 新区建筑不得超过3层
- Energy to come from 50% renewable energy
- 50%能源来自绿色能源
- 10-20% modern architecture in new village
- 新区现代建筑比例占10%-20%
- 33% maximum of canal system in new village to be exposed
- 新区水渠裸露部分不超过33%
- 2-story maximum along river promenade
- 沿河建筑不超过2层
- Local vegetation and materials to be utilized in landscaping
- 采用当地植物与材料造景
- Residential area to be located a minimum of two blocks from activity corridors
- 住宅区距离商业街2个街区以上



Water Network 水网系统

- Modern version of historic amenity
- 历史设施的新诠释
- Crop production
- 作物生产
- Minimize evaporation
- 蒸发量最小化

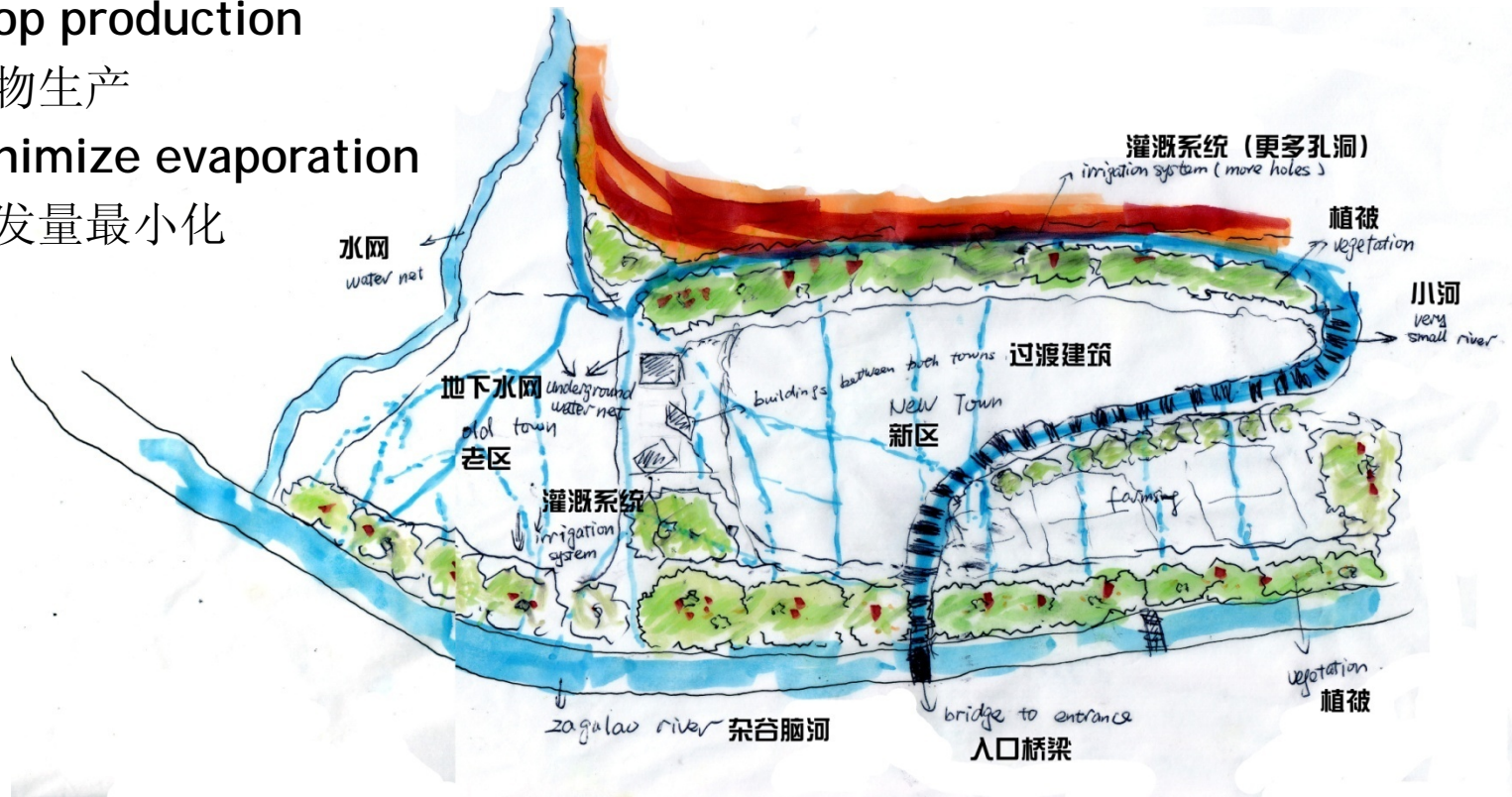

Public Space 公共空间

- Improve space for villagers and tourists to socialize and be active
- 改善供村民与游客社交活动的场所
- Create a main town square in the new village
- 在新区建设一个主广场
- Integrate local agriculture into the public space realm
- 当地农业与公共空间相结合



Architecture 建筑

• Modern versus Historic 新旧建筑对比

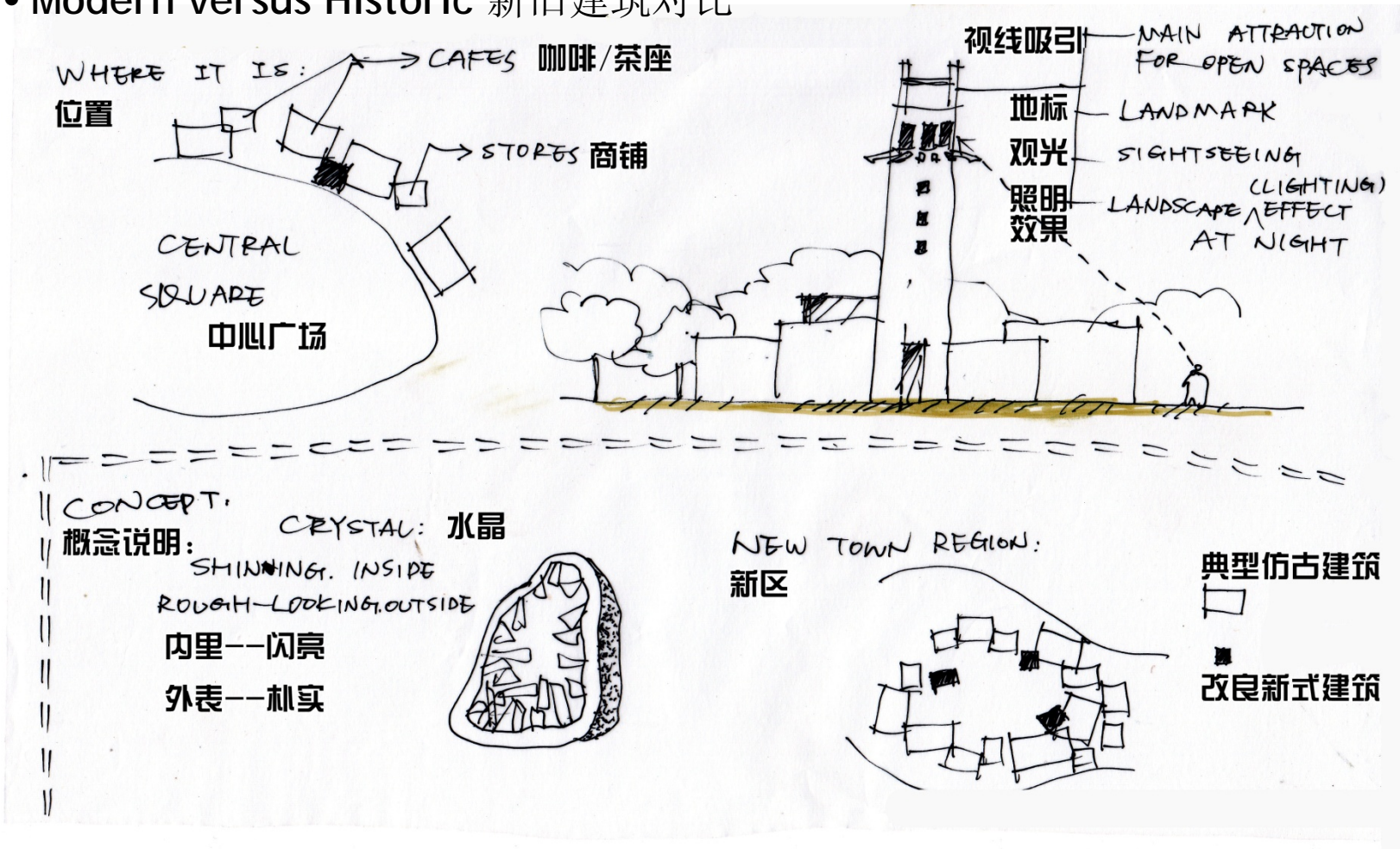

Architecture 建筑

• Modern versus Historic 新旧建筑对比

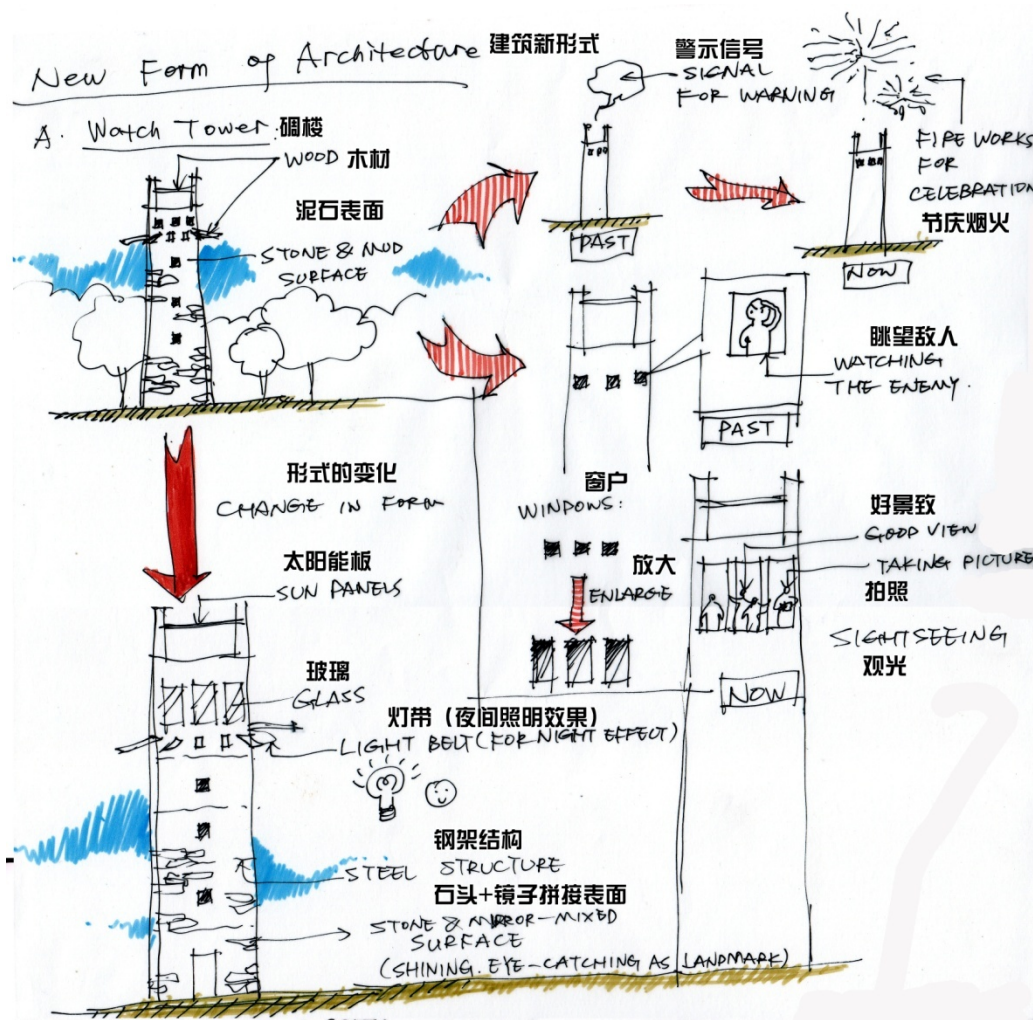

Architecture 建筑

- New building typology 新的建筑技术
- Cluster development - increase density 组团 - 密度增加

COURTYARD STYLE
BUILDINGS 中庭式住宅

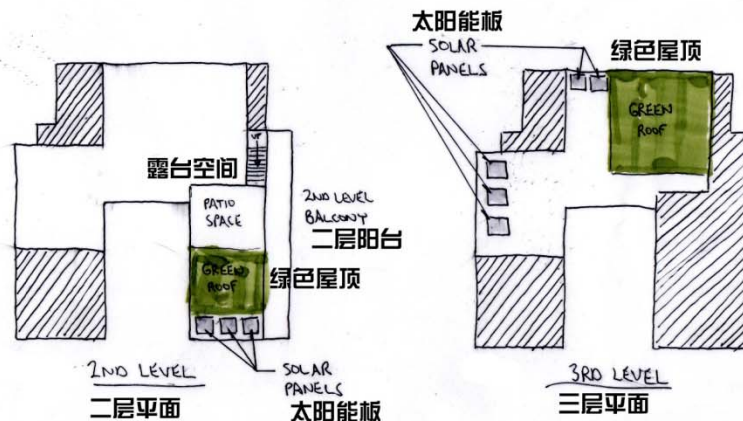
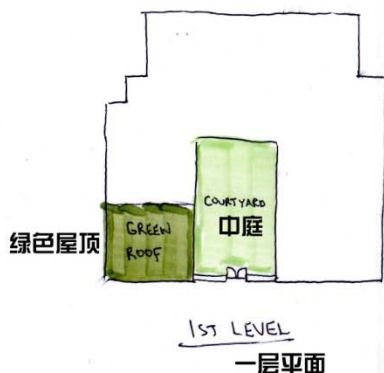

BUILDING ORIENTATION/DENSITY
CONCEPT

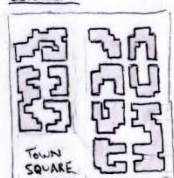

住宅朝向/密度
概念图

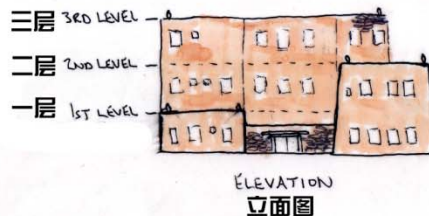

Sustainable Features of New Construction

新建设的可持续性

- Solar water heating
- 太阳能热水
- 50% solar/wind electricity
- 50%太阳能/风能发电
- Green roofs
- 绿色屋顶
- Low-flow fixtures
- 节水装置
- Operable/Low-E/double pane windows
- 节能玻璃窗
- Cisterns for roof drain water collection
- 屋顶雨水回收
- Constructed of 25% recycled materials
- 25%建材为回收材料



Summary 总结

- Preserve local culture with education and augmented by sustainable business practices.
• 通过教育手段以及可持续商业活动保护和提升当地文化
- Attract international visitors to a green technologies showcase.
• 通过绿色科技示范吸引世界游客
- Empower village residents through community participation.
• 通过社区参与为居民注入活力
- Restore farm land lost during construction, and reverse human impacts on the river's edge.
• 恢复建设中失去的农田，扭转人对河岸带来的影响

