

Electronic to-do list

View tasks by individual or group.

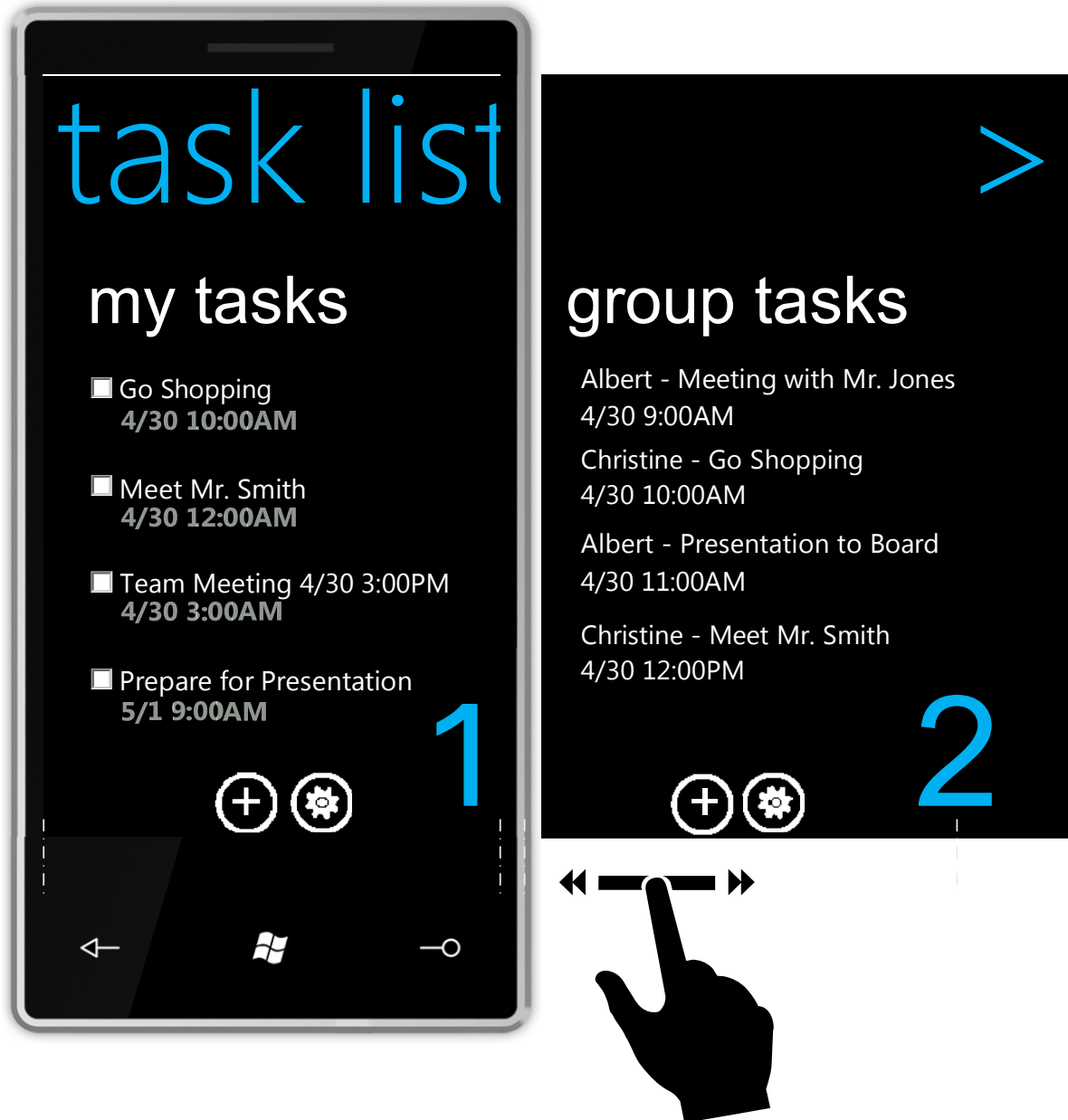

View details for an existing task.



Add a new task or Edit and existing task.

The screenshot shows a mobile application interface with a black background. At the top, the text "task list" is displayed in a large, light blue font. Below it, the text "add/edit task" is shown in white. The form includes several input fields: "Task Name:" with a white text box, "Task Location:" with a white text box, "Assignment:" with two radio button options, "Date/Time:" with a white text box, "Weather:" with a white text box, and "Notes:" with a white text box. A blue number "1" is positioned to the right of the "Notes:" text box. Below the "Notes:" field is a circular icon containing a white letter "A". At the bottom of the screen, there is a navigation bar with three icons: a white left-pointing arrow, the Windows logo, and a white magnifying glass icon.

task list

add/edit task

Task Name:

Task Location:

Assignment:

- Assigned To:
- By Location

Date/Time:

Weather:

Notes: 1

← Windows 🔍

Enter / update location criteria on a task.

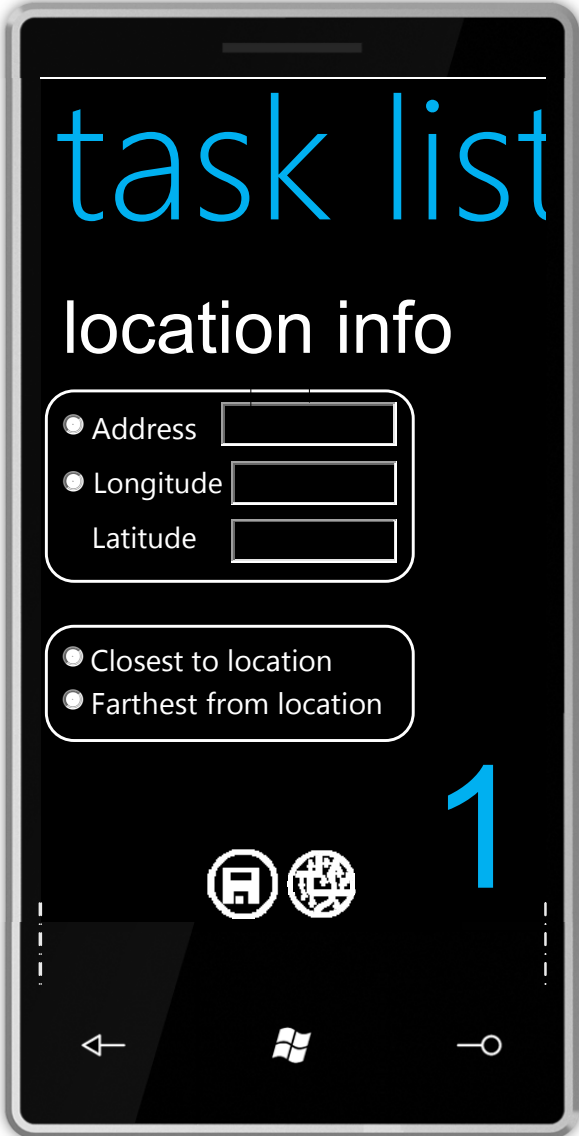

Enter / Update weather criteria on a task.

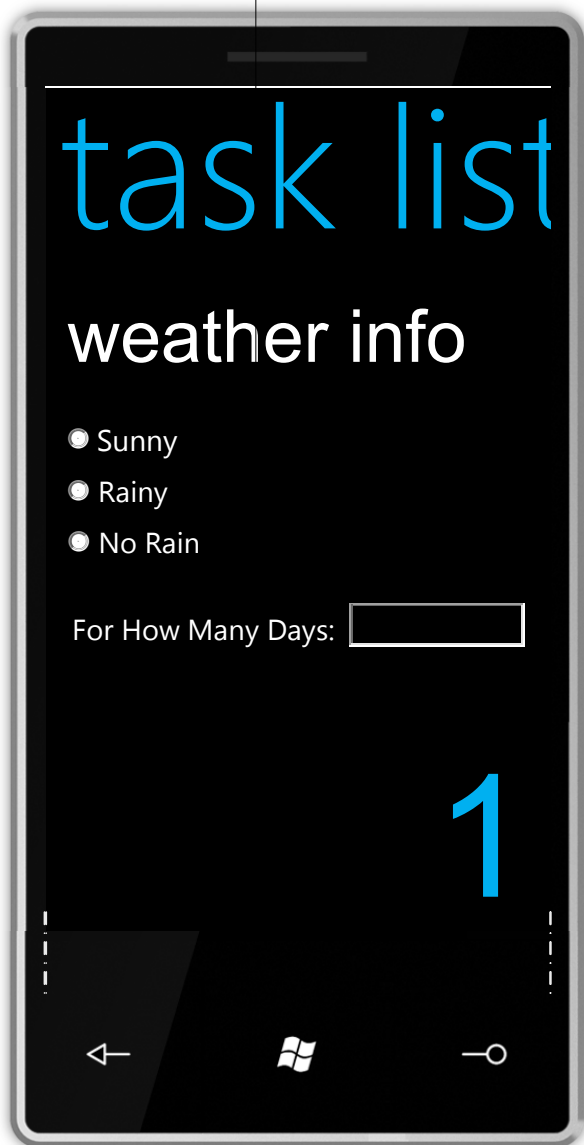

Task alert notifications:

