

MID AND LONG TERM



SHOP FRONT IMAGES AND USES

Use sidewalks as a Flexible Zone that can be used for market, art and event activities.

ORDINARY USE (SEATABLE BAR)

ALTERNATIVE 1: Keeping Parking Lanes + Wide Shop



ALTERNATIVE 2: Keeping Parking Lanes + Flexible Use + Trees



ALTERNATIVE 3: Using Parking Lanes + Flexible



SAMPLE SCENARIO

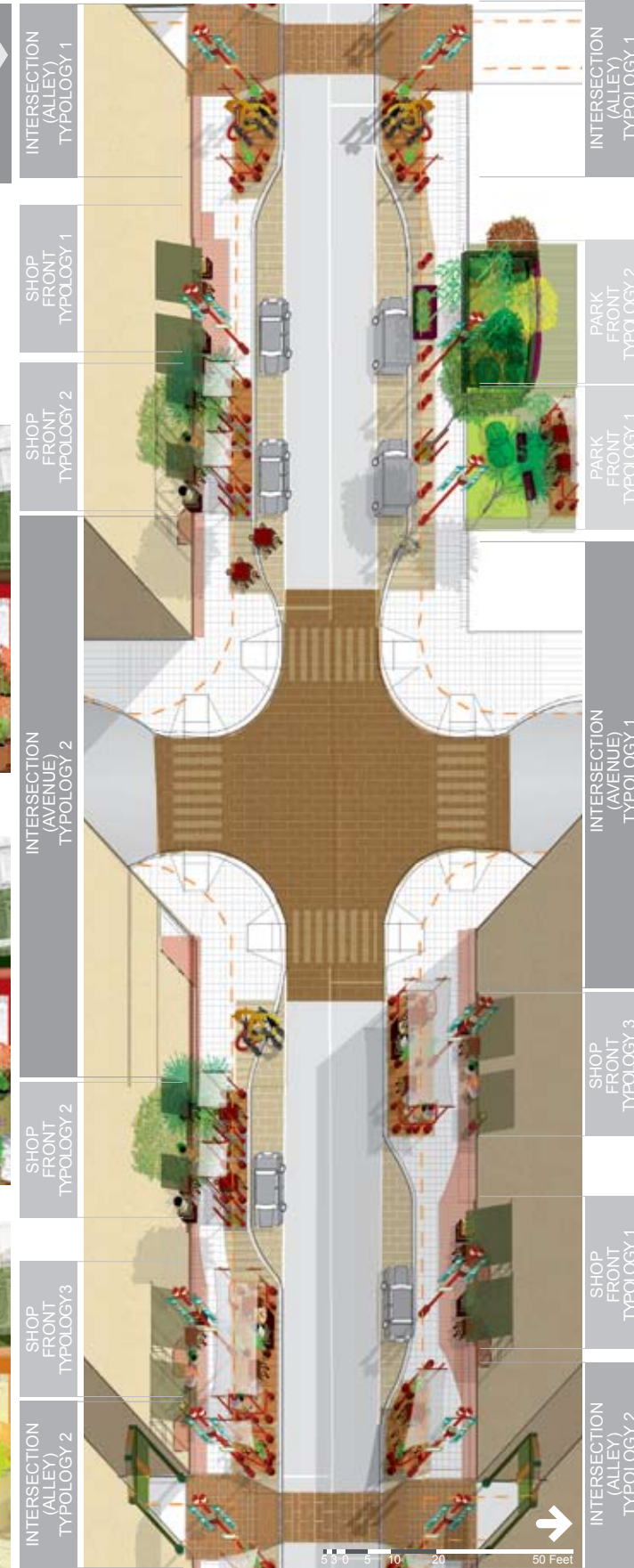

KING STREET VISION PROJECT

CHINATOWN king street
Enhancing Pedestrian Experiences

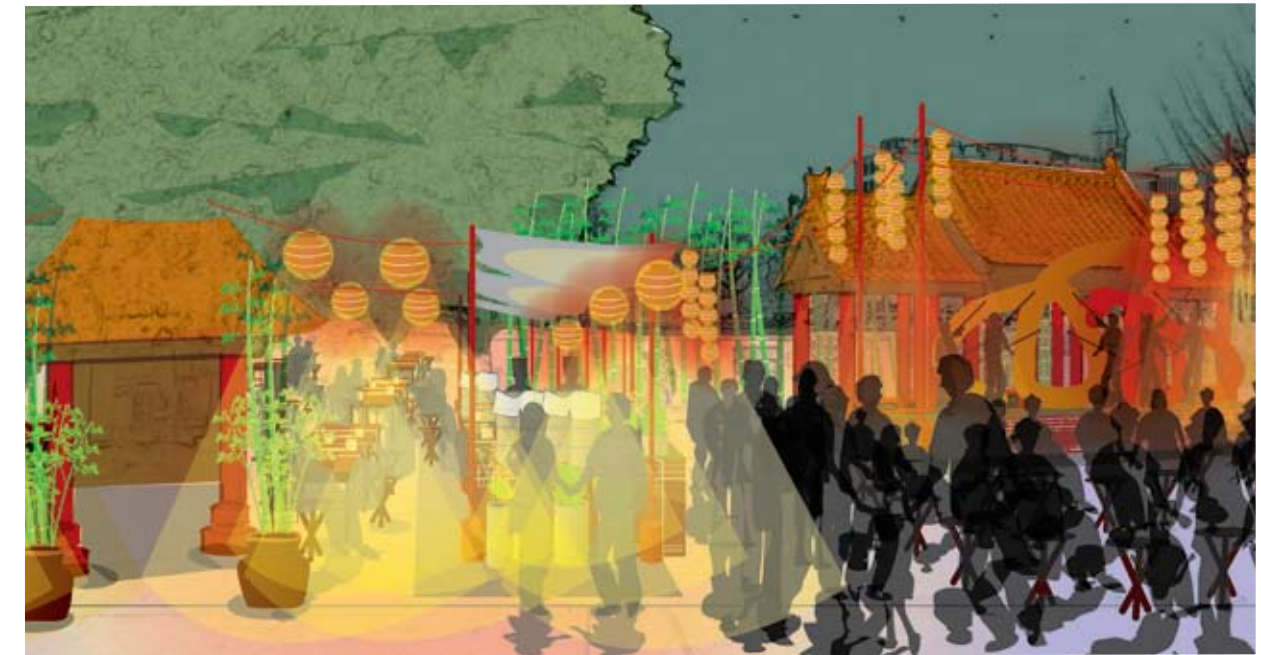

Hing Hay Park Image in Short Term Phase: Prospered with Events and Night Markets



Street Typical Section in Long Term Phase: Allowing for Flexible Use Responding to Contexts

This project is intended to enhance the pedestrian experiences on King Street through activities and designs. The specific goals of our project are to: (1) highlight the cultural and historical value; (2) encourage commercial activities and pedestrian movement; (3) maintain economical sustainability, and; (4) create flexible and multifunctional space, based on assets of the community. Overall improvements of street designs require both short-term and mid/ long-term strategies. The short-term phase aims at activating diverse cultural, traditional and commercial events along the street and encouraging pedestrian activities by introducing flexible street furniture. The mid/long-term phase involves expanding the existing sidewalks and other permanent enhancements.

金街新面貌

AJ Yang | Erica Huang | Yosuke Oi
King Street Vision Project

L ARCH 503 Community Design Studio | Winter 2009 | Jeff Hou

For more information and to download this pamphlet, visit: <http://courses.washington.edu/kingst/>

SHORT TERM



PARKING LOT Utilize less busy periods of the Uwajimaya parking as temporary market and event spaces.

EVENT

PEAK TIME USE (CURRENT USE)
 Ex. AM 9:00 - 11:00/ PM 1:00 -

ALTERNATIVE 1: MORNING MARKET/ EVENT
 Ex. Until AM 9:00 or Varying by event dates and times

ALTERNATIVE 2: MOBILE VENDOR LUNCH SERVICE
 Ex. AM 11:00 - PM 1:00

MOVABLE PLANTERS/ FURNITURE Put temporarily portable planters, and movable chairs and tables on sidewalks.

SIDEWALKS

- Pedestrian Flows on the Sidewalk
- Pedestrian Flows out of Shop Front
- Portable Planter
- Movable Furniture

BANNER Install designed banners reflecting Chinatown's features.

SIDEWALKS

Seattle Chinatown/ International District
 2009
 丑
 西雅圖 中國城

ALTERNATIVE 1: LIGHT POLE ATTACHMENT

ALTERNATIVE 2: WALL ATTACHMENT

DESIGN EXAMPLE: CHINATOWN, LA

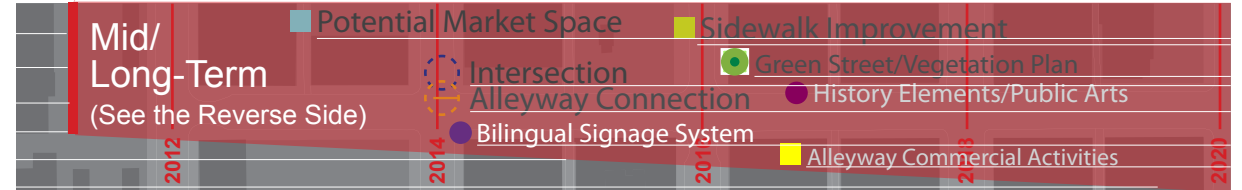

Hold events once per a month, and night market twice per a month, at Hing Hay Park.

ALTERNATIVE 1: NIGHT MARKET

ALTERNATIVE 2: FESTIVAL EVENTS

ALTERNATIVE 1: MORNING MARKET

ALTERNATIVE 2: MOBILE MARKET

ALTERNATIVE 1: MOVABLE PLANTERS

ALTERNATIVE 2: MOVABLE CHAIRS

ALLEY CLEAN-UP!!/ ART EXHIBITION SPACE
 Clean up and use alleys as art exhibition spaces, especially Guangdong Alley.

ALTERNATIVE: ART EXHIBITION USE

ART CULTURE LIGHT GREEN

金街新面貌

PARK

PARKING LOT

SIDEWALKS

ALLEYS