

# Project: Silk'en Seattle

## Night Market Furnitures Installation Guide

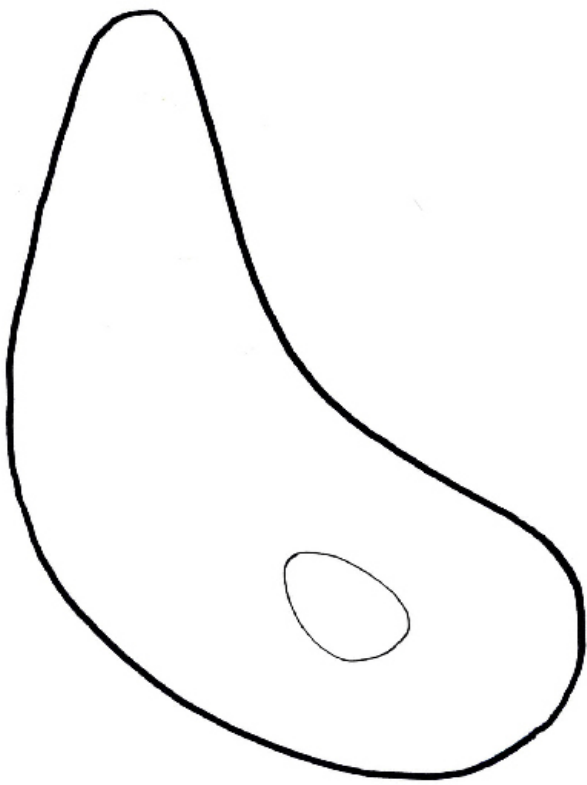
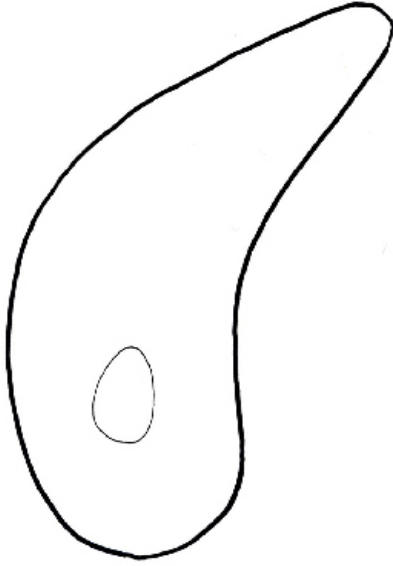
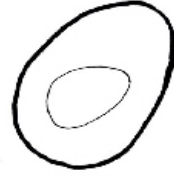

### Design Concept:

The Silk Road of Eurasia tied continent to island and desert to lagoon. It brought culture and commerce that united humanity. The night market of Chinatown-international District also connects community and commerce. This connection is facilitated by sleek island inspired benches that provide space for pause. Illumination from within the benches creates a beacon to their presence. Shadow box contents show the integration of community and commerce and the passage of time. A wish slot encourages community interaction. Slide together nesting components ease set up and storage, fitting form and function.

A collaborative project of Cultural Landscape Studio (Department of Landscape Architecture, University of Washington) and WILD Youth Program (International District Housing Alliance). Instructor: Jeff Hou; Youth Facilitators: Guihui Yuan, Carmen Cruz; WILD Program: Joyce Pisanont, Alan Lee, Amalia Gonzalez-Kahn. Autumn 2006. Design Team: Luke Anderson, Rebecca Chaney, Xiaowei Zhang, Quen Tran, Tiffany Tse

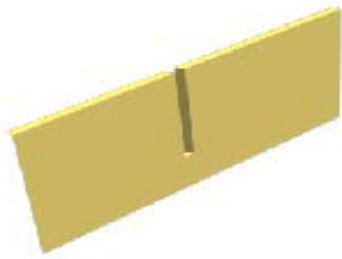

support pieces - total 11

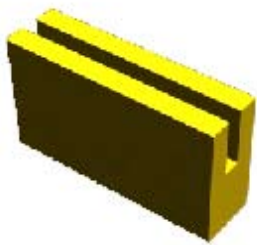

feet - total 18

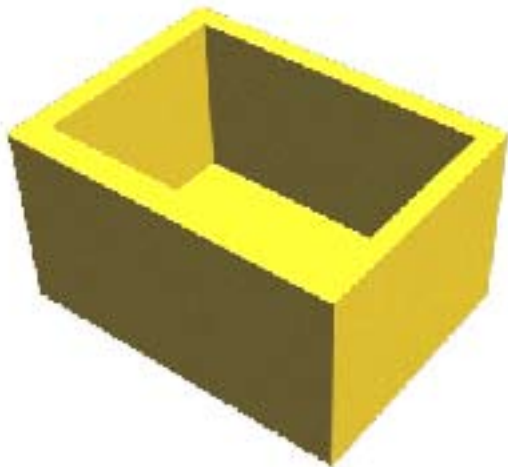

display boxes - total 2



bench tops - total 3

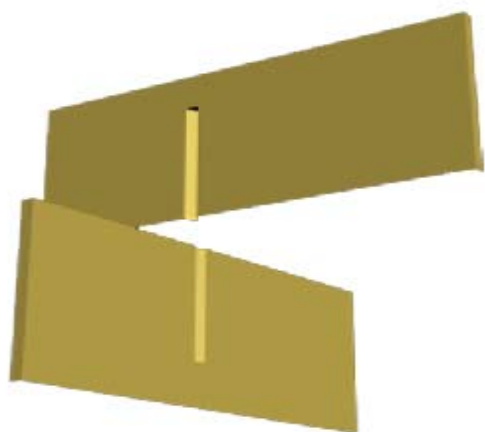

Support pieces slide together to form a structure to hold the bench

1. sort support pieces by main color
2. colored edges of supports indicate upper edge
3. supports with slit on the bottom slide over support with slit at the top - place lower support on the ground and slide upper support over the top and gently push toward ground until supports are interlocked

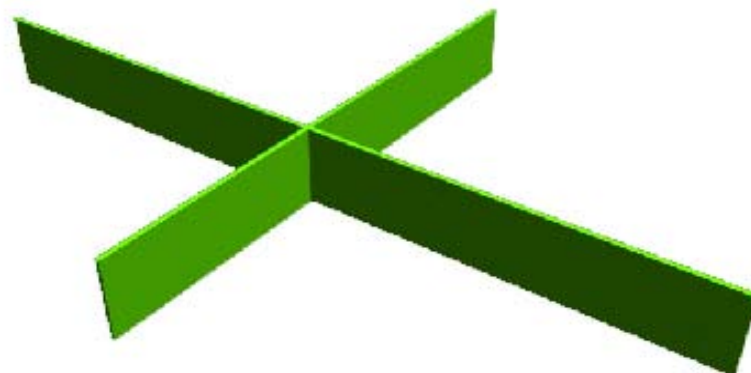

Small bench:

2 pieces with green top

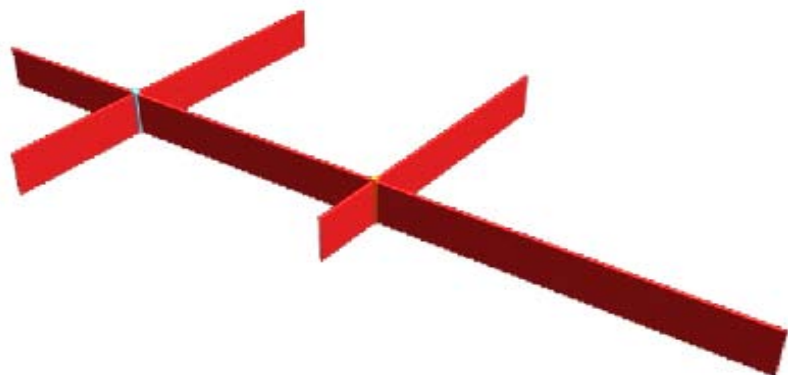

Medium bench:

3 pieces with red tops

match the colors that occur where pieces interlock

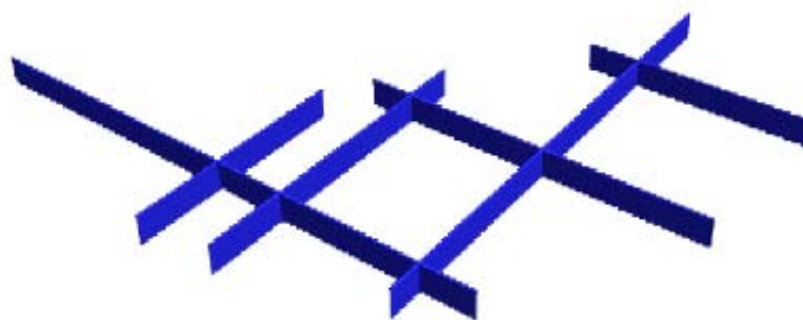

Large bench:

6 pieces

match the colors that occur where pieces interlock

\*slide pieces gently but firmly together without twisting

\*if pieces become difficult to assemble wax the edges with parafin so they slide smoothly

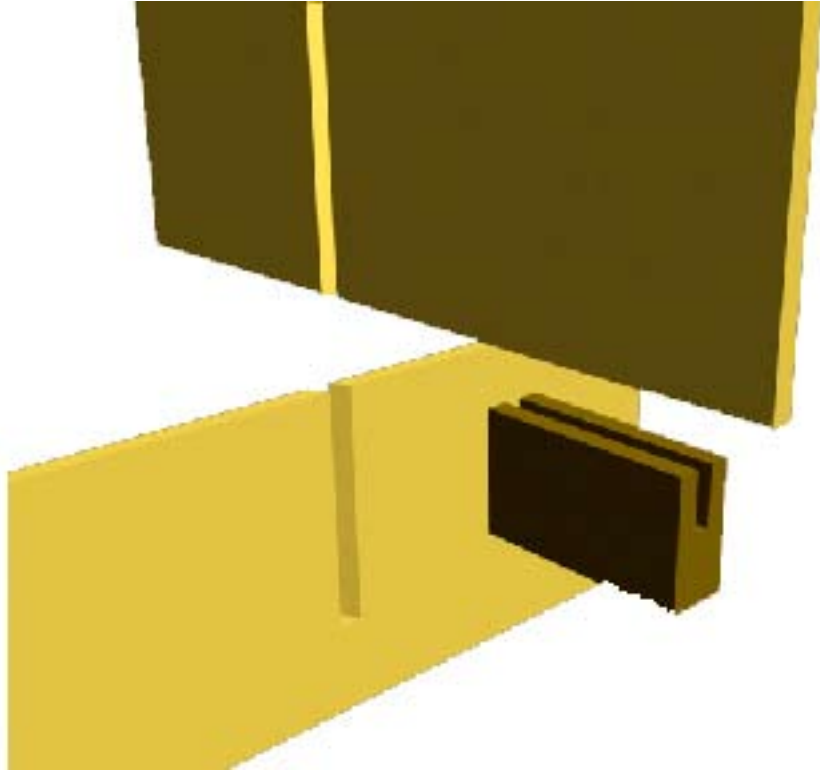

4. Slide a foot onto the supporting structure - place one at each foot outline



Display box:

5. place desired items in display box
6. place display box onto frame found on support structure
7. fill light with batteries (8 AA required per light) and turn on

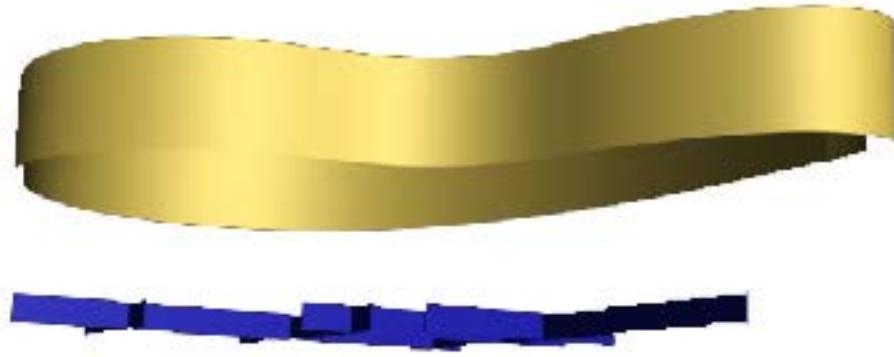

Place bench top over support

8. lower bench top slowly over supports
9. rotate and adjust until all supports are inside bench
10. when bench is on support gently shake until bench slides all the way down - it should be evenly positioned 2 inches above ground level

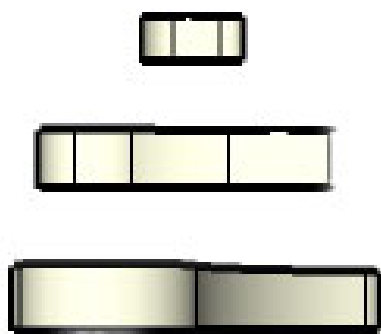

To store

1. Lift bench tops from supports and nest all three together
2. slide display boxes out from support structure
3. Remove feet
4. Slide apart support structure
5. Stack flat pieces together

**Labor requirement:**

2 people minimum, 3 optimum

**Time requirement:**

20 minutes first time  
10 with practice

**Parts needed:**

8 AA batteries per light

**Maintenance needs:**

1. Refill lights with batteries as needed
2. Regularly wax support slits for smooth sliding
3. Recoat bench tops annually with low emission, water based sealer

Requirements: people, time, parts, maintain-  
ance                      Improvements

**Improvements:**

1. Add a flood light under each bench to enhance floating affect
2. Reinforce lower edge of benches to increase strength and durability
3. Add adjustable feet to accommodate varying slopes
4. Redesign support structure for increased stability and light penetration