

# community activities

## Data collected from natural villages of:

- **QianPu** (a natural village designated for commercial redevelopment)  
Surveyed 36 people: 24 migrants and 12 residents  
(The migrants have been in Huoju for an average of 4 years.)
- **DaFang** (a natural village designated for industrial redevelopment)  
Surveyed 30 people: 22 migrants and 8 residents  
(The migrants have been in Huoju for an average of 3 years.)

Thursday, July 8 & Friday, July 9:  
Photo activity with children: Small groups of children in the community were given disposable cameras and asked to photograph things about their environment that they either liked or didn't like.



Sunday, July 11: Community survey activity: In the natural villages of Xianpu and Dafang, adults were surveyed regarding their physical environment, and the survey questions were posted so as to be publicly visible. The children's photographs from the previous photo activity were posted so that both the children and community adults could comment and react. Children were also invited to draw "ideal places;" these drawings were then posted near the temple for all participants to see. This combination of activities involved community members of all ages and interests and provided an informal forum in which they could state their opinions regarding the state of their community. (See survey results at right)



## Question-by-question survey results:

### 1. Temples

Do you go to the temple regularly?

- Local residents go to the temple more regularly than do migrants.
- Most residents surveyed go regularly, while very few migrants go regularly.

Would you oppose tearing down the temple?

- The majority of local residents would oppose tearing down the temple; migrants are more varied - equal amounts would not oppose, oppose, or have no opinion.
- Some migrants comment that the temple is for local residents and they do not believe in the local temple deity themselves.
- The majority in Dafang oppose because they believe the temple is a historic site.
- The majority in Qianpu oppose because it is a part of their faith.

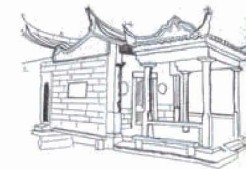

### 2. Large trees and green space

Do you think large trees should be preserved?

- Both residents and migrants say that large trees should be preserved. None of the migrants surveyed said that large trees should not be preserved.
- Many Dafang respondents commented that there are no large trees in their community.

Would you build factories, housing, or parks on the vacant land in the community?

- The majority of residents and migrants would prefer parks or green space to be built on the vacant land in the community.
- More migrants than residents would prefer that factories be built on the vacant land in the community.
- More residents than migrants would prefer that housing be built on the vacant land in the community.
- More migrants than residents have no opinion regarding what should be planned for the vacant land in the community.
- Many respondents in both Qianpu and Dafang say that there are no spaces for leisure activities.
- Many respondents mentioned the positive aspects of having green space and parks, such as better air quality.
- The migrants who preferred that factories be built said that new factories could create more job opportunities.



### 3. Traditional housing

Would you prefer to live in old or new housing?

- The majority of residents and migrants would prefer to live in new housing.
- Respondents commented that new housing has better conditions and lighting while promoting better living quality. Old housing is dilapidated and ugly.
- Two respondents commented that if they built new housing now, they would own both the land and the building sitting upon it.
- One respondent commented that old housing promotes better relationships between neighbors.
- One migrant said that she prefers to live in old housing because it reminds her of her home in her native place.
- One migrant said that she prefers to live in old housing because it is more affordable.

Would you oppose tearing down old housing?

- The majority of residents and migrants would not oppose tearing down old housing.
- A few of the respondents commented that old housing with traditional characteristics should be preserved, but the dilapidated old housing could be torn down.

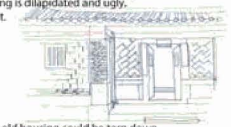

### 4. Basketball courts

Do you use the basketball courts frequently?

- The majority of residents and migrants use the basketball court frequently.
- In Dafang, some respondents would also use it as a space for general exercise.

Would you oppose converting the basketball courts into factories or housing?

- The majority of residents and migrants would prefer that the basketball courts remain.
- Some residents and migrants would approve of converting the basketball courts if needed for housing or factory use.
- There are no undecided residents, but only a few of the migrants have no opinion as to whether they would oppose converting the basketball court.
- Most respondents commented that they would oppose this action because the community lacks space for leisure activities.
- Some would agree to convert the courts only if they were replaced with new ones.



### 5. Community markets

Where do you usually shop for food?

- The majority of residents and migrants do not shop in community markets.
- Migrants often distinguished during the interview that they shopped in different locations depending on how much time they had in which to do their shopping.
- Many respondents commented that markets inside or outside the community are dirty and poorly managed. Particularly in Dafang, many commented that the community market is expensive, does not have much of a selection, and is dirty.
- Many commented that the markets in Dafang and Qianpu are more expensive than those outside of those communities.



### 6. Are there other important places in the community that were not asked about?

- Most said no.
- Rather than telling us what are some of the other important places, some respondents thought that this question was meant to ask about what else may be lacking in the community.
- Some respondents said that they have little time to spend outside in the community; they spend their time either at home or at work.
- Factories were also mentioned as important places because of the amount of time migrants spend at work or at the factories' facilities.
- One respondent in Dafang mentioned the school.